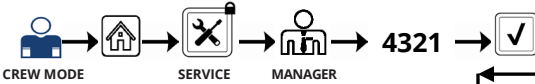

# LOV-T Menu Update Instructions

Follow these instructions to update menu files.

## Step 1 - Update the menu

**IMPORTANT:** This menu update procedure **will overwrite** any current product menu items and their settings. It may be necessary to re-enter "limited time offer" products and their cook times, temperatures, etc. Ensure that any LTO or other menu items settings are captured prior to loading the menu files.

1. On the left screen, press  → **USB - MENU OPERATION** → **COPY MENU FROM USB TO FRYER**
2. The controller displays INSERT USB.
3. Open the far-left cabinet door and slide the USB cover up (see Figure 1).
4. Insert the USB flash drive into the USB port (see Figure 2).
5. The controller displays IS USB INSERTED? YES NO
6. Press the YES button after the USB flash drive is inserted.
7. Controller displays READING FILE FROM USB. PLEASE DO NOT REMOVE USB WHILE READING.
8. Controller displays UI - UI DATA TRANSFER IN PROGRESS changing to MENU UPGRADE IN PROCESS.
9. Controller displays UPGRADE COMPLETE? on **ALL** displays.
10. Press YES on **ALL** displays.
11. Controller displays MENU UPGRADE COMPLETED, REMOVE THE USB AND RESTART THE ENTIRE BATTERY.
12. Remove the USB flash drive and lower cover over the USB slot.

## Step 2 - Power Cycle the Fryer

1. To power cycle the system, PUSH and HOLD the black toggle reset switch for **60 SECONDS**. The reset switch is located either under the USB port, near the USB port or under the left control box (see photos to the right). If the switch is not accessible, unplug the fryer or turn off the breaker to the fryer. Failure to press and hold the reset switch long enough, may cause an incomplete menu file update.

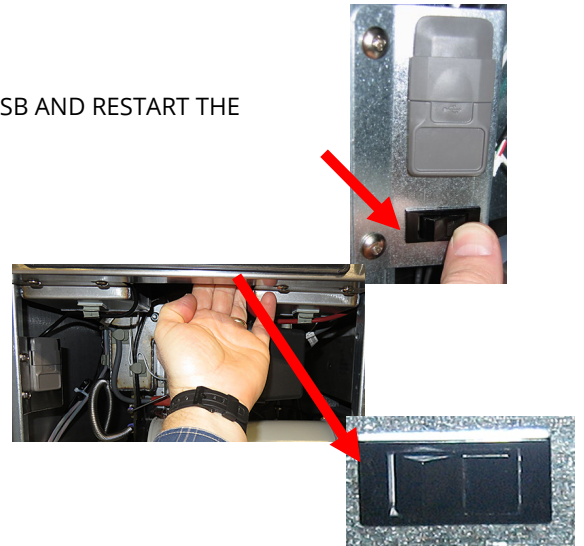

## Step 3 - Reassign/Add Products

1. Products may need reassigned to their locations and any limited time offerings products may need to be reentered into each controller.